

Mortice lock SL, round ends with cylinder lock, 85 mm centre, 22 mm forend

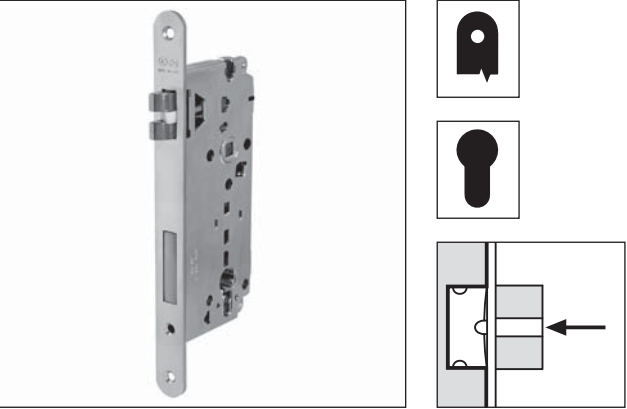

Description

Embedded lock with spring latch and bolt, to be used in combination with a DIN V 18254 profile cylinder. 85 mm centre. 22 mm forend with round. 45 and 70 mm backsets. Reversible lever latch made of sintered steel which guarantees an optimal closing even in combination with self closing device. Holes for mounting handles with through screws, Tenax and C-liner. Body and forend made of steel.

Application

For interior and main timber doors to be used with strikers dedicated to Opera SL.

Mounting

The lock eurogroove has a thickness of 16 mm (8 mm for each side from the lock axis). Secure the lock with two 4.5x25 mm screws. To reverse the spring latch, unscrew the pin from the lock back with a 4 mm Allen wrench, execute a rotation of 180°, fasten the central nylon insert to the lock and re-screw the pin.

NB. The striker and cylinder must be ordered separately.

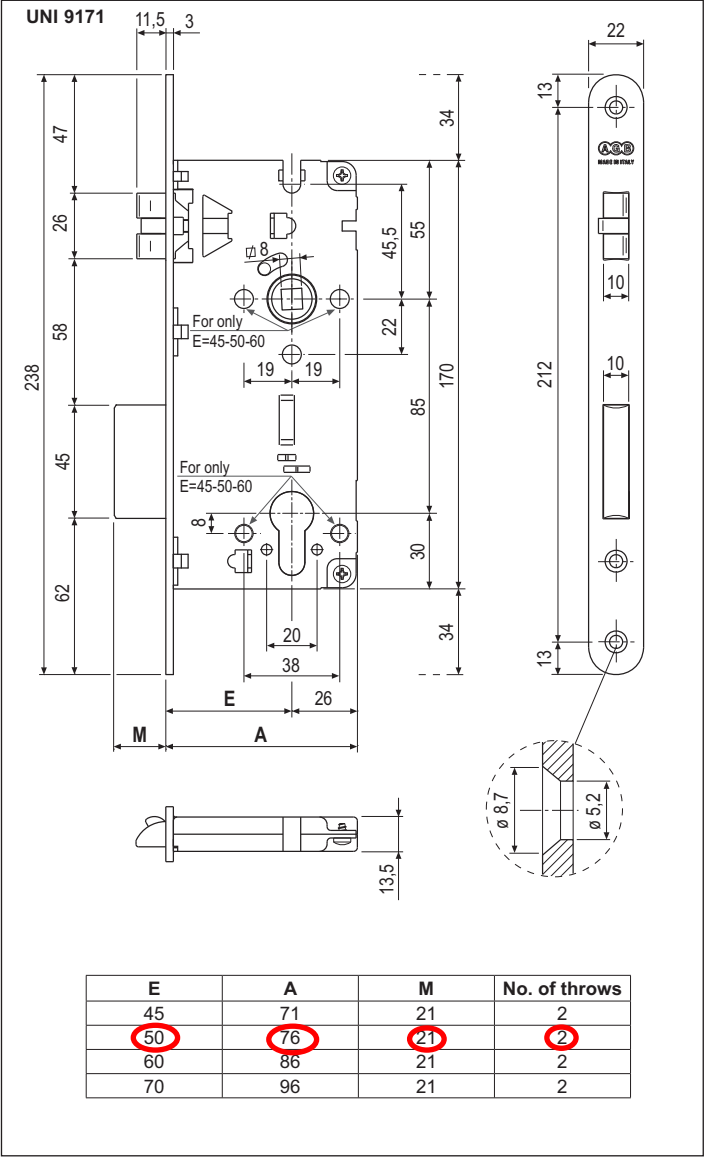

Order Specifications

Material	SALES CODE			Type
	Ref.	Backset	Finish	
STEEL	B54101	45-50-60-70	XX	r.h.
	B54102	45-50-60-70	XX	l.h.

NB. Refer to the price list in force to check the availability of the finishes.